



CONCRETE TEST STATION

REVISION 1

APPLICATION

A permanent durable test station used for the measurement of pipe to soil potentials, current flow, testing of insulated flanges, resistance bonds, anode outputs etc.

CONCRETE TEST STATION DATA

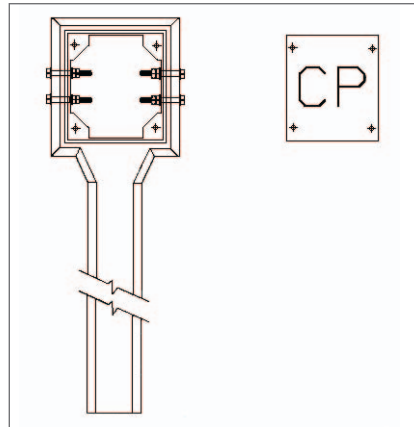

The test station consists of a preformed concrete post with a covered recess to contain a connection panel if required.

Cables are brought into the recess via a conduit inside the post thus rendering the station completely weatherproof.

- Total length : 1219 mm
- Depth : 95 mm.

The standard supply includes:

- Concrete test post
- Four brass bolts, nuts, fabric and steel washers
- Aluminium face plate (unmarked)

Optional extras include:

- Reed Switch – to enable IR free potential measurements to buried coupon without opening the test post
- Termination boxes
- Customised polycarbonate or Traffolyte cover plates